



PRO REELS SERIES

STX-75-3

75' (22.9 m) Retractable 14 AWG Power Cable Reel
Triple Tap with LED Indicator and Circuit Breaker

Efficient cable management solution for professional environments.

The Stage Ninja® STX-75-3 includes 75 feet (22.9 meters) of 14/3 power cable with an over-molded triple-tap 5-15R female connector, locking center tap, LED indicator, and a 10-amp onboard circuit breaker. The high-tension mechanism locks at any length and retracts smoothly. A 3-foot (0.91 meters) static lead ends in a 5-15P male plug, and the industrial-grade thermoplastic housing features a carry handle and optional swivel mount.

Key Features

Durable Black industrial-grade thermoplastic housing with integrated carrying handle

Retractable Smooth operation; locks at any length with high-tension mechanism

Reliable 75' (22.9 m) retractable 14/3 power cable with LED indicator and 10 A circuit breaker

Flexible Swivel wall or ceiling mounting bracket included

Serviceable Constant tension configuration available upon request

Custom options available to meet specific requirements. Call 317-829-1507 to learn more. Made in the USA. 

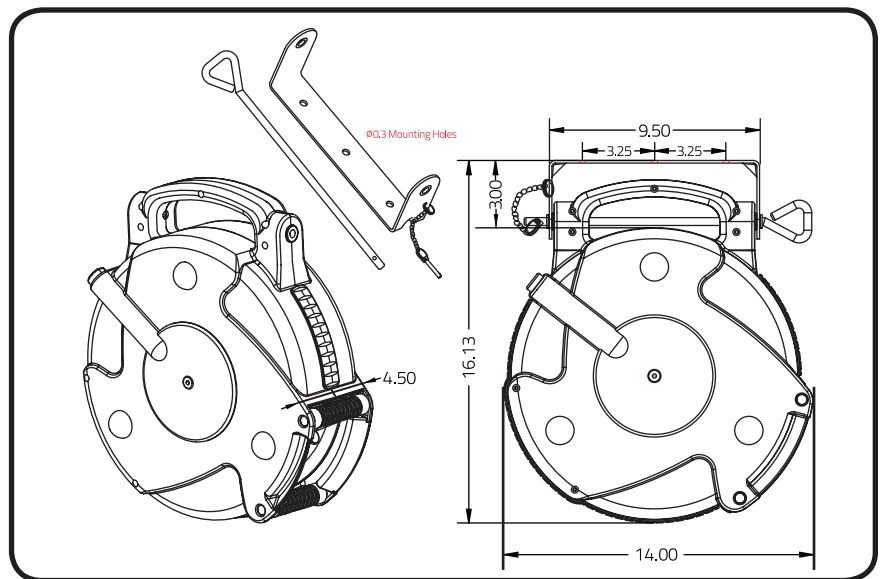

Reel Material
Retraction Length
Static Length
Connection

Industrial-grade thermoplastic
75 ft (22.9 m)
3 ft (0.91 m)
Triple tap 5-15R female with locking center tap and LED indicator; 5-15P male plug

Cable Type
Electrical Rating
Size

14 AWG, 3-conductor (14/3)
125 V, 10 A, 1250 W
Diameter 11.25" (28.6 cm); thickness: 3.75" (9.5 cm);
Reel diameter with handle: 13.25" (33.7 cm);
Hanging depth with bracket: 15" (38.1 cm)
Approximately 20 lbs (9.07 kg)

Weight
Spring Drive
Tension Adjustable
Mounting
Lock & Release
Warranty

Enclosed steel spring
Constant tension configuration available upon request
Eye hook and optional swivel wall or ceiling bracket
Pull-to-lock, pull-to-release mechanism
1-year limited warranty



Visit Stage Ninja



E-Mail Support



Terms & Conditions



Warnings

WARNING Read all instructions before use. This product can cause injury, including but not limited to burns, cuts, eye injuries, or amputation if the cord is misused or damaged. Recoil may cause injuries, especially when reconnecting. When unplugging, hold the cable end to maintain control. Avoid wrapping the cord around any appendage or body part. Wear long pants and protective gear to minimize the risk of burns or cuts from the retractable cord. The retractable cord is intended for use by responsible adults only. Keep out of reach of children. Do not allow anyone to touch or come into contact with the reel while in use. Stop using the retractable cable if it shows any signs of wear, damage, or does not function properly. Do not place hands, feet, head, or any other body part near the housing while the cord is extended. Please heed these warnings and exercise caution when using the retractable cable.